

State of New York

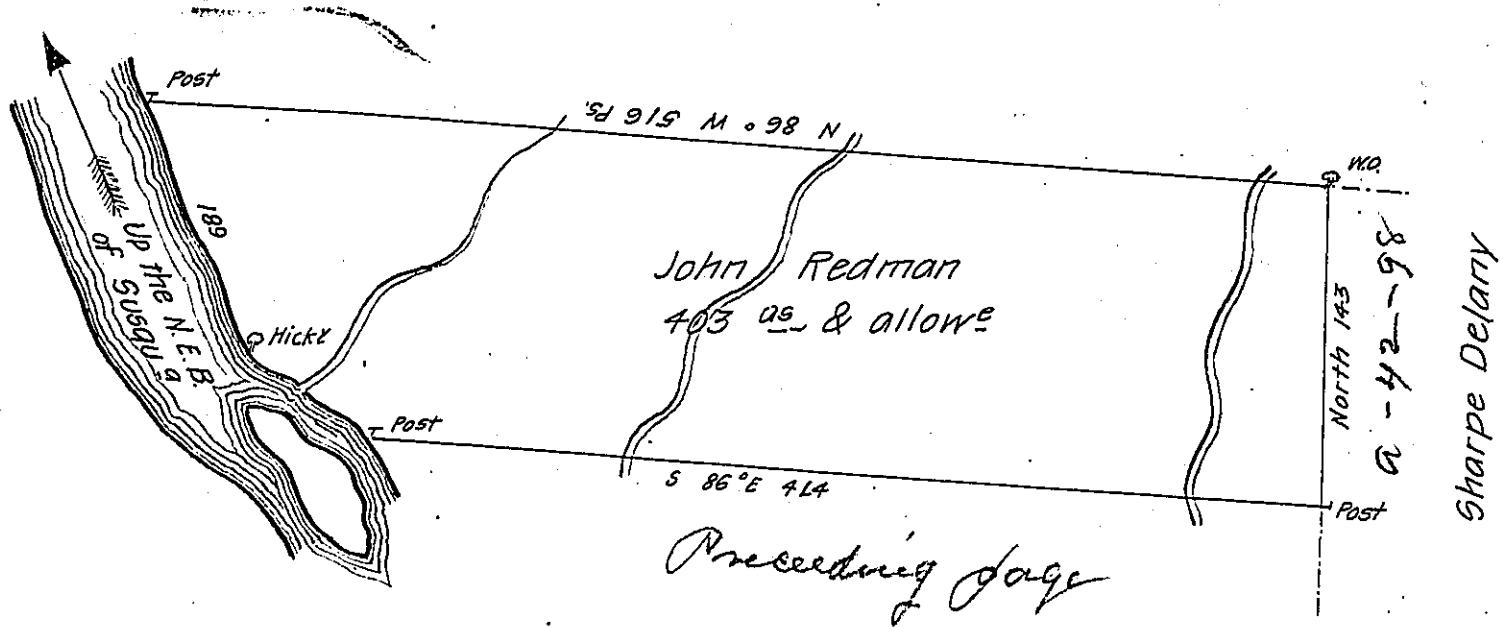

George Rambo

A draught of a tract of land called — Situate joining the New York line the N.E. Branch of *Sisqua* & Land surveyed for Sharpe Delany & others in Northumberland County Containing four hundred & three acres & allowe of Six P. Cent for Roads &c. Surveyed for John Redman the 7th day of Sept^r 1784 in Pursuance of a Warrant dated the 2^d day of July 1784

by

To John Lukens Esq^r

Wm Gray D.S.

Surv^r Gen^l

IN TESTIMONY that the above is a copy of the original remaining on file in the Department of Internal Affairs of Pennsylvania, made conformably to an Act of Assembly approved the 16th day of February, 1833, I have hereunto set my Hand and caused the Seal of said Department to be affixed at Harrisburg, this twenty first day of September 1906

Isaac R. Brown
Secretary of Internal Affairs.